

Ideal for handling special load carriers and closed pallets.

Small turning radius and low overall height for use in very confined spaces.

Forks and dimension between the wheel arms can be individually adjusted via adapters for additional flexibility.

Maintenance-free lithium-ion technology: high availability thanks to intermediate charging.

New entry-level lift height available with a lift of 46 inches.



## **EJC 110i (Fork Over) / EJC 110bi (Straddle)**

### **Electric Walkie Stacker (2,200 lbs.)**

The EJC 110i / EJC 110bi is the specialist in the entry-level segment of pedestrian-operated electric pallet trucks. Its particular strengths include the handling of special load carriers and closed pallets as well as the transverse pick-up of pallets.

The fork carriage of the EJC 110bi offers the possibility of installing specific optional attachments such as crane hooks or drum turners. The battery capacities can also be customized to individual requirements.

Thanks to its compact dimensions and small turning radius, the EJC 110i / EJC 110bi always remains agile and maneuverable - even in tight spaces. As an ergonomic lift table, it is ideal for loading machines. And its low overall height allows a good view of the forks and surroundings.

In short, the EJC 110i / EJC 110bi is an ideal solution for small to medium-sized companies that need to transport and store special load carriers, closed pallets or pallets crosswise.

# Technical data

as of: 05/2024

					Jungheinrich		Jungheinrich	
					EJC 110i		EJC 110bi	
<b>Characteristics</b>	1.1	Manufacturer						
	1.2	Model						
	1.3	Drive			electric		electric	
	1.4	Type of operation			pedestrian		pedestrian	
	1.5	Load capacity / rated load	Q	lbs / kg	2,200 / 1,000		2,200 / 1,000	
	1.6	Load center distance	c	in / mm	24 / 600		24 / 600	
	1.8	Load distance, center of drive axle to fork	x	in / mm	30.8 / 783		30.9 / 784	
	1.9	Wheelbase	y	in / mm	46.1 / 1,171		46.0 / 1,168	
	<b>Weights</b>	2.1	Service weight (with 50Ah Power Pack)		lbs / kg	1,056 / 480	1,133 / 515	
2.2		Axle loading – loaded, drive / load		lbs / kg	1,100 / 2,156 / 500 / 980	1,166 / 2,167 / 530 / 985		
2.3		Axle loading – unloaded, drive / load		lbs / kg	770 / 286 / 350 / 130	814 / 319 / 370 / 145		
<b>Chassis</b>	3.1	Tires			PU (polyurethane)		PU (polyurethane)	
	3.2	Tire size - drive			Ø 210 x 70		Ø 210 x 70	
	3.3	Tire size - load			Ø 75 x 70 / Ø 75 x 45		- / Ø 85 x 75	
	3.4	Additional wheels – dimensions			Ø 140 x 54		Ø 140x 54	
	3.5	Wheels – number, drive / load (x = driven wheels)			1x+1/2		1x+1/2	
	3.6	Tread width, drive	b <sub>10</sub>	in / mm	20.0 / 507		20.0 / 507	
	3.7	Tread width, load	b <sub>11</sub>	in / mm	15.5 / 394		39 / 45 / 53 / 992 / 1,162 / 1,362	
<b>Dimensions</b>	4.2	Collapsed mast height		h <sub>1</sub>	in / mm	77.6 / 1,970	77.6 / 1,970	
	4.3	Free-lift		h <sub>2</sub>	in / mm	3.9 / 100	59.4 / 1,510	
	4.4	Maximum fork height (MFH)		h <sub>3</sub>	in / mm	60.6 / 1,540	59.4 / 1,510	
	4.5	Overall extended height (OAE)		h <sub>4</sub>	in / mm	77.6 / 1,970	77.6 / 1,970	
	4.9	Handle height in drive position – minimum / maximum		h <sub>14</sub>	in / mm	29.5 / 49.6 / 750 / 1,260	29.5 / 49.6 / 750 / 1,260	
	4.15	Lowered fork height		h <sub>13</sub>	in / mm	3.5 / 90	3.5 / 90	
	4.19	Length to fork face – headlength		l <sub>1</sub>	in / mm	67.5 / 1,714	67.5 / 1,714	
	4.20	Length including fork shank		l <sub>2</sub>	in / mm	22.2 / 564	22.2 / 564	
	4.21.1	Overall width		b <sub>1</sub>	in / mm	31.5 / 800	42.7 / 49.4 / 57.2 / 1,084 / 1,254 / 1,454	
	4.22	Fork dimensions		s / e / l	in / mm	2.4 / 7 / 45.3 / 60 / 178 / 1,150	2.4 / 7 / 45.3 / 60 / 178 / 1,150	
	4.25	Width across forks		b <sub>5</sub>	in / mm	21.1 / 535	21.1 / 535	
	4.26	Inside dimension of support / straddle legs		b <sub>4</sub>	in / mm	- / -	35.4 / 42.1 / 50.0 / 900 / 1,070 / 1,270	
	4.32	Ground clearance – center of wheelbase		m <sub>2</sub>	in / mm	1.1 / 27	2.0 / 51	
	4.34.1	Aisle width (for 48 x 40 pallets (L x W)) incl. clearance		Ast	in / mm	87.3 / 2,218	87.3 / 2,218	
4.35	Turning radius		Wa	in / mm	54.9 / 1,394	55.0 / 1,396		
<b>Performance</b>	5.1	Travel speed – loaded / unloaded		mph / kph	3.3 / 3.3 / 5.3 / 5.3	3.3 / 3.3 / 5.3 / 5.3		
	5.2	Lift speed – loaded / unloaded		ft / min / m / s	29.5 / 49.2 / 0.15 / 0.25	29.5 / 49.2 / 0.15 / 0.25		
	5.3	Lowering speed – loaded / unloaded		ft / min / m / s	29.5 / 29.5 / 0.15 / 0.15	29.5 / 29.5 / 0.15 / 0.15		
	5.7	Maximum gradeability – loaded / unloaded		%	6 / 10	6 / 10		
	5.10	Service brake			generative	generative		
	<b>Motors</b>	6.1	Drive motor, performance S <sub>2</sub> 60 min.		kW	1	1	
6.2		Lift motor, performance with S <sub>3</sub>		kW	1.2	1.2		
6.4		Battery voltage / nominal capacity		V / Ah	24 / 50/100	24 / 50/100		
6.6.1		Energy consumption according to EN cycle		kWh/h	0.66	0.66		
6.6.2		CO2 equivalent as per EN 16796		lbs/h / kg/h	0.9 / 0.4	0.9 / 0.4		
<b>Other</b>		8.1	Type of drive control			AC	AC	
	10.7	Sound level as per EN12053, operator's ear		dB (A)	65	65		

This specification sheet only provides technical values for the standard truck. Non-standard tires, different masts, additional equipment, etc., could produce other values. Rights reserved for technical changes and improvements.

# EJC 110i (Fork Over) / EJC 110bi (Straddle)

## EJC 110i (Fork Over)

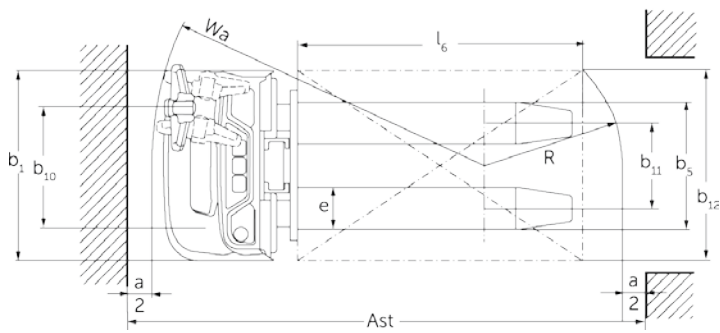
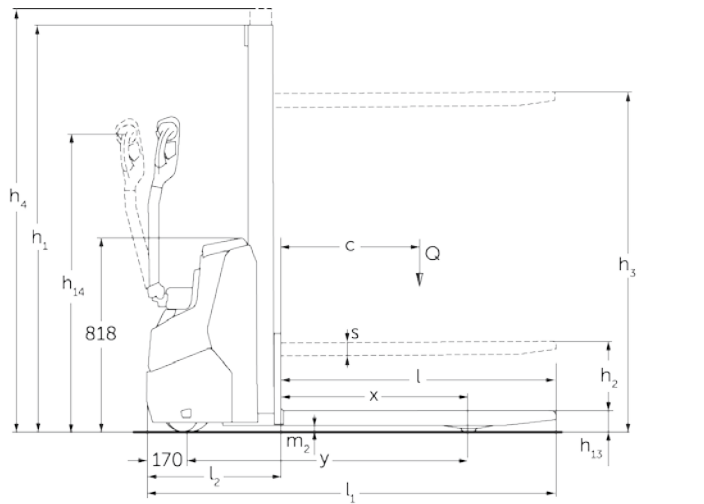

## EJC 110bi (Straddle)

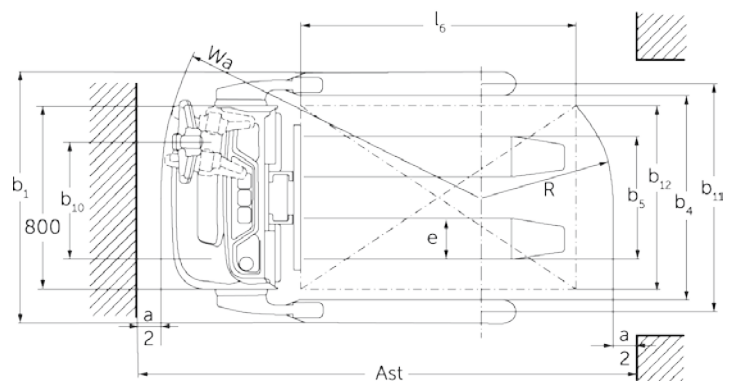
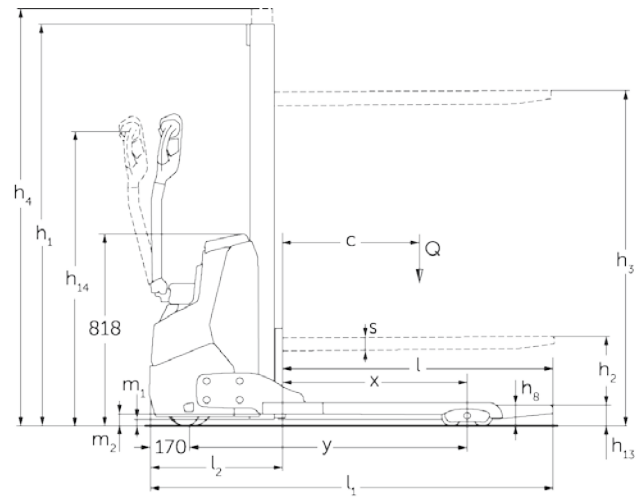

Note: Equipping this model (these models) with a power source (e.g. Lithium-ion, Hydrogen Fuel cell, etc.) that has not been previously approved by the factory is considered a modification. Per OSHA 1910.178 and ANSI/ITSDF B56.1, please consult with your factory representative prior to installing any non-OEM power source that has not been previously approved.

# The Jungheinrich Advantage



## Efficiency

Compact and flexible in day-to-day work.

The space-saving design of the state-of-the-art lithium-ion technology allows the EJC 110bi to be used flexibly in tight spaces.

Flexible in use

- Compact and maneuverable, making it ideal for small or confined areas.
- Low overall height and good visibility of the forks favor precise and easy handling of loads.
- Proportional lifting and two-stage lowering for precise positioning.
- Proportional lowering available as an option.

Energy-efficient

- Flexible charging at any standard socket.
- Energy-saving function: Truck switches off automatically when not in use - reducing charging costs.
- High voltage stability.
- Battery capacity can be selected depending on the intended application.

Lithium-ion technology

- Fast and intermediate charging for maximum availability.
- No battery change necessary:
- Zero maintenance saves time and money.
- Up to 3 times the service life of lead-acid batteries.
- High-quality battery management system.



## Awareness

For optimum protection in day-to-day work.

Jungheinrich's sophisticated and proven solutions help protect people, goods and machines.

Intelligent and easy to use

- Intuitive handling thanks to simple operation concept.
- Optimal sight on forks, loads and surrounding areas.
- Simplified maneuvering in confined spaces thanks to crawl mode with raised tiller.
- Body protection switch integrated in the tiller head for additional operator protection.
- Four-wheel chassis and widened wheel arms help create a firm and stable stance.

Optional features

- Load indication shows the weight during lifting.
- A buzzer during the lifting process helps pedestrians recognize the truck in the area.
- Charger power cord protection circuit detects when power cord is properly stowed.



## Individuality

Customized to your personal requirements:

With the Jungheinrich EJC 110i / EJC 110bi electric pallet truck, you can perform various tasks such as transporting, lifting, stacking, storing and retrieving - and much more - efficiently and in a space-saving manner.

Universal all-rounder

- Handling (lifting, lowering, transporting) of special load carriers and closed pallets as well as order picking of goods.
- Usage as a lift or work table brings goods to an ergonomic working height.
- Multiple access systems such as EasyAccess or PinCode.
- Option holder for customized accessories.
- Document compartment on the hood suitable for paperwork.

Various configuration options

- Includes built in charger and integrated Lithium-ion battery with optional increased battery Ah allowing flexible integration into your logistics processes.
- 3 different lifting heights (from 46 inches) for different applications.
- 2-inch truck display provides language-independent information on truck and battery status using symbols.

Parts when you need them

- Jungheinrich's Parts Fast or Parts Free Guarantee ensures next-business-day delivery by 5:00 PM of all Jungheinrich parts in the United States, or they're free, including freight. For customers in Canada and Mexico, the guarantee ensures shipping of parts within 24 hours from the time the order was placed by the dealer. See your local Jungheinrich dealer for program details.

\* Programs may be subject to change without notice and may vary by region. Please ask your local Jungheinrich dealer for complete terms and conditions.

\*\* The product shown may be different than the actual configuration based on market requirements.